

INSTRUCTION

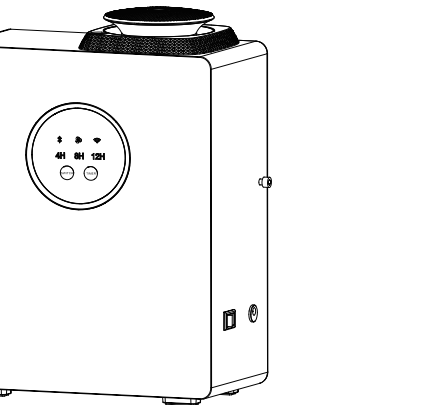

Scent Diffuser User Manual

Product introduction

This fragrance device aroma dispersion system is designed using two-phase atomization technology, a regional area fragrance dispersion device, with an intelligent PCB control program. The product can be placed independently and can also be wall-mounted or connected to the central fresh air conditioning system. The product has a stylish appearance and precise and stable fragrance dispersion. Its main function is to create different fragrance tones for life and is suitable for hotels, airports, office buildings, cinemas, high-end shopping malls, entertainment clubs and other places.

To meet the needs of different customers, we have equipped the device with the following three options:
1. WiFi version: by connecting the device to WiFi through a mobile APP, the device can be controlled in the same network even when the user is not present.
2. Bluetooth version: by connecting the device to the mobile APP via Bluetooth, the device can be controlled.
3. Normal version: the device's working state can be controlled manually through the touch panel.

Attentions

Please read this user manual carefully before using the device and keep it for future reference.

1. Do not use overloaded power outlets, damaged power cords or adapters, as this may pose a safety hazard to you. To avoid fire hazards, replace them immediately if you notice any damage.
2. If you are not a technician, please do not attempt to modify, disassemble, or repair the device. This may cause damage to the device. If the device malfunctions, check if it was operated according to normal usage requirements or follow the troubleshooting guide. If the problem persists, please contact the seller promptly.
3. Do not invert or tilt the device while in use. Before transporting the device to another location, clean and maintain the device (see device maintenance instructions) before packing it for transportation. This will prevent essential oils from seeping into the device and damaging it.
4. Regularly maintain and clean the device to ensure that it remains in optimal working condition.

Instruction of Essential Oi

1. Before refill canister with essential oil, please turn off the device for 2 minutes till oil of atomizer back to canister then take off the oil canister.
2. It is recommended to control the amount of essential oil within 45 days each time to avoid deterioration of essential oil due to oxidation.

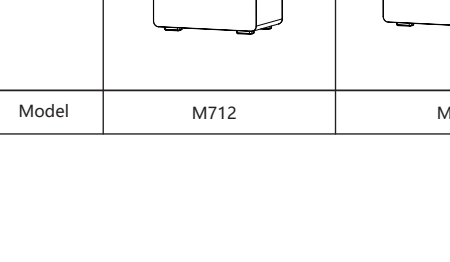

Parameters

Size	W202*D121.2*H322.5(mm)	W242*D121.2*H322.5(mm)	W289*D126.2*H322.5(mm)
Capacity	1000ml	1000ml	1000ml
N.W	3.9KG	4.6KG	6.3KG
Coverage	3000m³	5000m³	8000m³
Voltage	DC12V-2A	DC12V-2A	DC12V-3A
Power	12W	15W	25W
Noise	≤40dB	≤42dB	≤46dB
Package size	W248*D181*H390(mm)	W288*D181*H390(mm)	336*D186*H390(mm)
Appearance			
Model	M712	M717	M718

Accessories

Item	Power adapter	Key	Hanging panel	User manual	Atomizer core	Seal ring	Expansion screw
Diagram							
Item	Hexagonal wrench	HVAC connector	Pipe				
Diagram							

Installation

1. Open the lock with the key, pull the atomizer head upward to take out the oil canister.
2. Fill the oil canister with essential oil, then install the atomizer head back with oil canister.
3. Put in the atomizer head and align it with the slot, then lock the atomizer head.
4. Connect to the power supply, turn on the power switch, then set the working time, the equipment can start to work now.

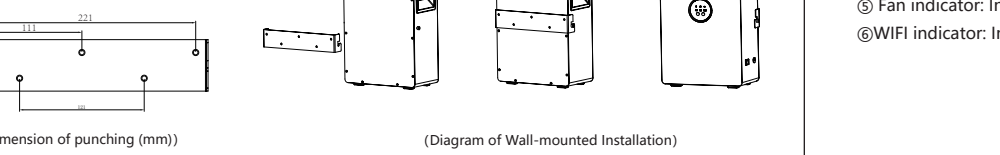

Accessories

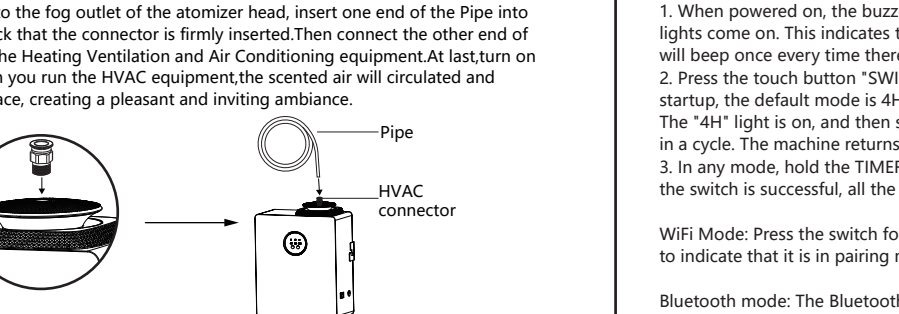

Installation

1. Open the lock with the key, pull the atomizer head upward to take out the oil canister.
2. Fill the oil canister with essential oil, then install the atomizer head back with oil canister.
3. Put in the atomizer head and align it with the slot, then lock the atomizer head.
4. Connect to the power supply, turn on the power switch, then set the working time, the equipment can start to work now.

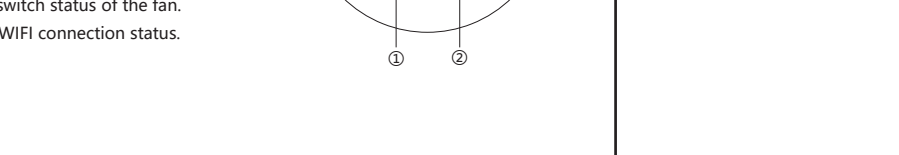

Accessories

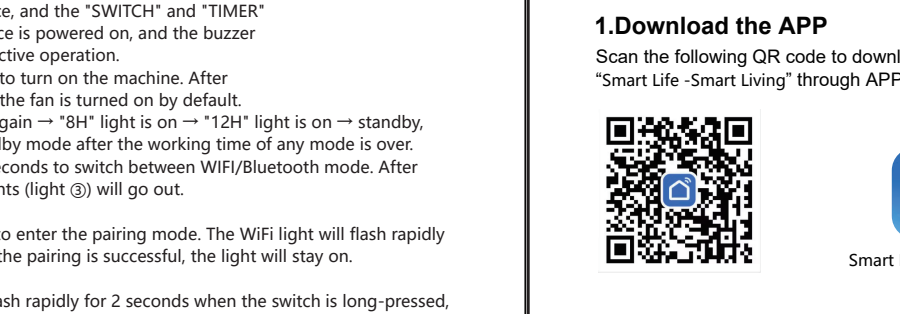

Installation

1. Open the lock with the key, pull the atomizer head upward to take out the oil canister.
2. Fill the oil canister with essential oil, then install the atomizer head back with oil canister.
3. Put in the atomizer head and align it with the slot, then lock the atomizer head.
4. Connect to the power supply, turn on the power switch, then set the working time, the equipment can start to work now.



Accessories

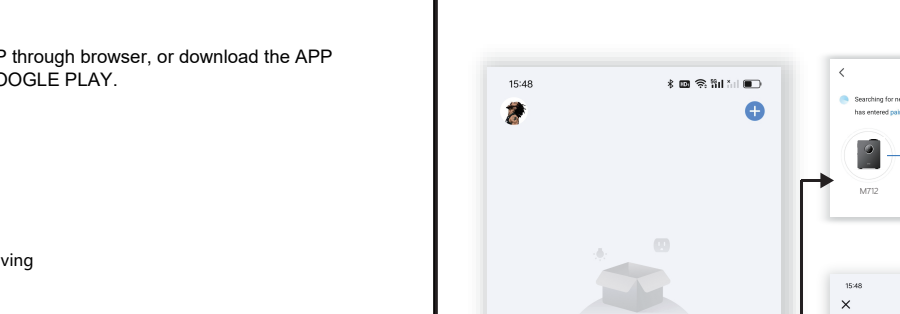

Installation

1. Open the lock with the key, pull the atomizer head upward to take out the oil canister.
2. Fill the oil canister with essential oil, then install the atomizer head back with oil canister.
3. Put in the atomizer head and align it with the slot, then lock the atomizer head.
4. Connect to the power supply, turn on the power switch, then set the working time, the equipment can start to work now.

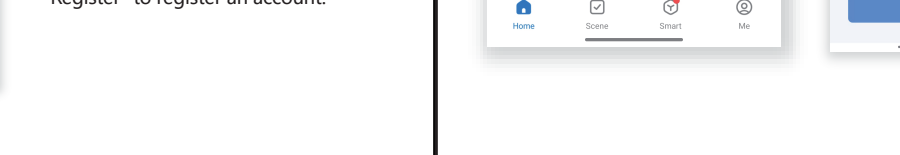

Accessories

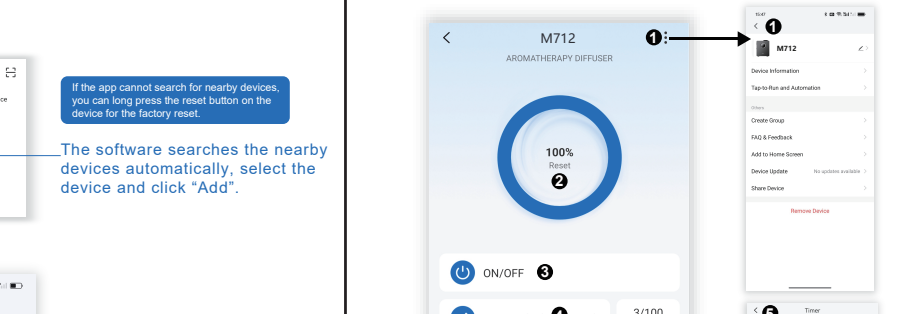

Installation

1. Open the lock with the key, pull the atomizer head upward to take out the oil canister.
2. Fill the oil canister with essential oil, then install the atomizer head back with oil canister.
3. Put in the atomizer head and align it with the slot, then lock the atomizer head.
4. Connect to the power supply, turn on the power switch, then set the working time, the equipment can start to work now.

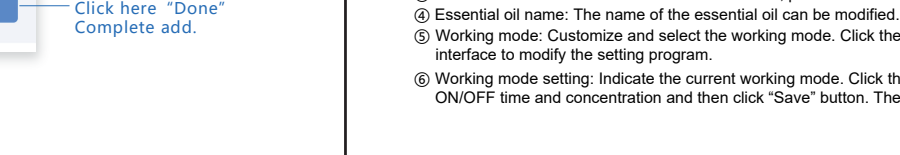

Accessories

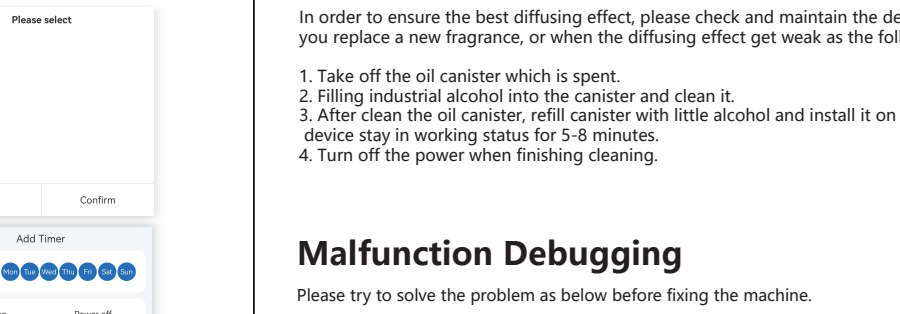

Installation

1. Open the lock with the key, pull the atomizer head upward to take out the oil canister.
2. Fill the oil canister with essential oil, then install the atomizer head back with oil canister.
3. Put in the atomizer head and align it with the slot, then lock the atomizer head.
4. Connect to the power supply, turn on the power switch, then set the working time, the equipment can start to work now.

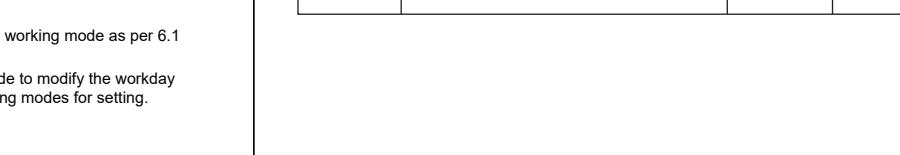

Accessories

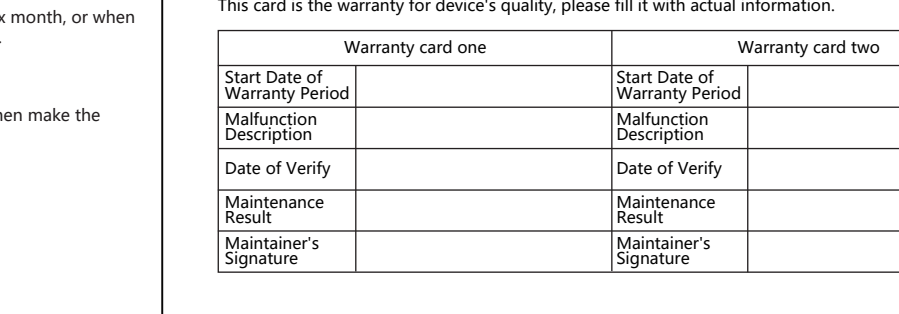

Installation

1. Open the lock with the key, pull the atomizer head upward to take out the oil canister.
2. Fill the oil canister with essential oil, then install the atomizer head back with oil canister.
3. Put in the atomizer head and align it with the slot, then lock the atomizer head.
4. Connect to the power supply, turn on the power switch, then set the working time, the equipment can start to work now.

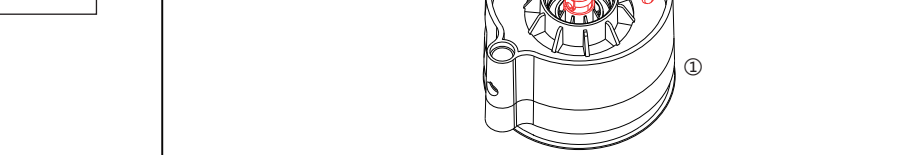

Accessories

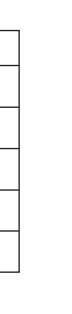

Installation

1. Open the lock with the key, pull the atomizer head upward to take out the oil canister.
2. Fill the oil canister with essential oil, then install the atomizer head back with oil canister.
3. Put in the atomizer head and align it with the slot, then lock the atomizer head.
4. Connect to the power supply, turn on the power switch, then set the working time, the equipment can start to work now.



Control panel

Air outlet

Power interface

Switch

Dimension of punching (mm)

Diagram of Wall-mounted Installation

Dimension of punching (mm)

Diagram of Wall-mounted Installation

Dimension of punching (mm)

Diagram of Wall-mounted Installation

Control panel

Air outlet

Power interface

Switch

Dimension of punching (mm)

Diagram of Wall-mounted Installation

Dimension of punching (mm)

Diagram of Wall-mounted Installation

Dimension of punching (mm)

Diagram of Wall-mounted Installation

Control panel

Air outlet

Power interface

Switch

Dimension of punching (mm)

Diagram of Wall-mounted Installation

Dimension of punching (mm)

Diagram of Wall-mounted Installation

Dimension of punching (mm)

Diagram of Wall-mounted Installation

Control panel

Air outlet

Power interface

Switch

Dimension of punching (mm)

Diagram of Wall-mounted Installation

Dimension of punching (mm)

Diagram of Wall-mounted Installation

Dimension of punching (mm)

Diagram of Wall-mounted Installation

Control panel

Air outlet

Power interface

Switch

Dimension of punching (mm)

Diagram of Wall-mounted Installation

Dimension of punching (mm)

Diagram of Wall-mounted Installation

Dimension of punching (mm)

Diagram of Wall-mounted Installation

Control panel

Air outlet

Power interface

Switch

Dimension of punching (mm)

Diagram of Wall-mounted Installation

Dimension of punching (mm)

Diagram of Wall-mounted Installation

Dimension of punching (mm)

Diagram of Wall-mounted Installation

Control panel

Air outlet

Power interface

Switch

Dimension of punching (mm)

Diagram of Wall-mounted Installation

Dimension of punching (mm)

Diagram of Wall-mounted Installation

Dimension of punching (mm)

Diagram of Wall-mounted Installation

Control panel

Air outlet

Power interface

Switch

Dimension of punching (mm)

Diagram of Wall-mounted Installation

Dimension of punching (mm)

Diagram of Wall-mounted Installation

Dimension of punching (mm)

Diagram of Wall-mounted Installation

Control panel

Air outlet

Power interface

Switch

Dimension of punching (mm)

Diagram of Wall-mounted Installation

Dimension of punching (mm)

Diagram of Wall-mounted Installation

Dimension of punching (mm)

Diagram of Wall-mounted Installation

Control panel

Air outlet

Power interface

Switch

Dimension of punching (mm)

Diagram of Wall-mounted Installation

Dimension of punching (mm)

Diagram of Wall-mounted Installation

Dimension of punching (mm)

Diagram of Wall-mounted Installation

Control panel

Air outlet

Power interface

Switch

Dimension of punching (mm)

Diagram of Wall-mounted Installation

Dimension of punching (mm)

Diagram of Wall-mounted Installation

Dimension of punching (mm)

Diagram of Wall-mounted Installation

Control panel

Air outlet

Power interface

Switch

Dimension of punching (mm)

Diagram of Wall-mounted Installation

Dimension of punching (mm)

Diagram of Wall-mounted Installation

Dimension of punching (mm)

Diagram of Wall-mounted Installation

Control panel

Air outlet

Power interface

Switch

Dimension of punching (mm)

Diagram of Wall-mounted Installation

Dimension of punching (mm)

Diagram of Wall-mounted Installation

Dimension of punching (mm)

Diagram of Wall-mounted Installation

Control panel

Air outlet

Power interface

Switch

Dimension of punching (mm)

Diagram of Wall-mounted Installation

Dimension of punching (mm)

Diagram of Wall-mounted Installation

Dimension of punching (mm)

Diagram of Wall-mounted Installation

Control panel

Air outlet

Power interface

Switch

Dimension of punching (mm)

Diagram of Wall-mounted Installation

Dimension of punching (mm)

Diagram of Wall-mounted Installation

Dimension of punching (mm)

Diagram of Wall-mounted Installation

Control panel

Air outlet

Power interface

Switch

Dimension of punching (mm)

Diagram of Wall-mounted Installation

Dimension of punching (mm)

Diagram of Wall-mounted Installation

Dimension of punching (mm)

Diagram of Wall-mounted Installation

Control panel

Air outlet

Power interface

Switch

Dimension of punching (mm)

Diagram of Wall-mounted Installation

Dimension of punching (mm)

Diagram of Wall-mounted Installation

Dimension of punching (mm)

Diagram of Wall-mounted Installation

Control panel

Air outlet

Power interface

Switch

Dimension of punching (mm)

Diagram of Wall-mounted Installation

Dimension of punching (mm)

Diagram of Wall-mounted Installation

Dimension of punching (mm)

Diagram of Wall-mounted Installation

Control panel

Air outlet

Power interface

Switch

Dimension of punching (mm)

Diagram of Wall-mounted Installation

Dimension of punching (mm)

Diagram of Wall-mounted Installation

Dimension of punching (mm)

Diagram of Wall-mounted Installation

Control panel

Air outlet

Power interface

Switch

Dimension of punching (mm)

Diagram of Wall-mounted Installation

Dimension of punching (mm)

Diagram of Wall-mounted Installation

Dimension of punching (mm)

Diagram of Wall-mounted Installation

Control panel

Air outlet

Power interface

Switch

Dimension of punching (mm)

Diagram of Wall-mounted Installation

Dimension of punching (mm)